

(Son Cotoner)

Ref: ONPM2603001



## 8 New Nuild homes in Son Cotoner

In the established and increasingly sought-after neighborhood of Son Cotoner, we present this charming and quiet new-build development consisting of only 8 exclusive homes. A building designed for those who value privacy, comfort, and quality of life in a well-connected urban environment. The development offers 2- and 3-bedroom homes, including a penthouse and top-floor penthouse with terrace, all designed to maximize natural light, functionality, and everyday well-being. Every detail has been carefully selected to provide a modern, elegant, and long-lasting home. Strategic location Located just 15 minutes from Palma's city center and 15 minutes from schools, the area benefits from excellent public transport connections and easy access to shops, pharmacies, and all essential daily services. Living here means enjoying peace and quiet without giving up city life. Quality and finishes The homes stand out for their high-quality materials and equipment from leading brands: Porcelain stoneware tiling in kitchens, utility rooms, and bathrooms. White lacquered interior woodwork with frames, side-edged doors, quality hinges, and Tesa-style handles or similar. Reinforced [...]

Palma de Mallorca / Son Cotoner

Unit bj A

Completion Q1 2026

### FEATURES

Surface 56 m<sup>2</sup> / 19 m<sup>2</sup> terrace

2 Rooms

1 Toilets

- ✓ AACC
- ✓ Lift

Price 370,000 €

(Son Cotoner)

Ref: ONPM2603001



(Son Cotoner)

Ref: ONPM2603001



Planta baja (nivel +0.20m)

SUP ÚTIL INTERIOR	44,69 m <sup>2</sup>
SUP CONSTRUIDA INTERIOR	54,06 m <sup>2</sup>
SUP ÚTIL EXTERIOR	14,75 m <sup>2</sup>
SUP PPZC	71,36 m <sup>2</sup>

- Salón / Comedor / Cocina
- 2 Dormitorios
- 1 Baño
- Jardín privado



\* Ver anexo. Explicación de superficies.

(Son Cotoner)

Ref: ONPM2603001

Primera Planta (nivel +3.20m)

SUP. ÚTIL INTERIOR	44,47 m <sup>2</sup>
SUP. CONSTRUIDA INTERIOR	55,57 m <sup>2</sup>
SUP. ÚTIL EXTERIOR	-
SUP. PPZC	70,72 m <sup>2</sup>

- Saló / Comedor / Cocina
- 2 Dormitorios
- 1 Baño



\* Ver anexo. Explicación de superficies.

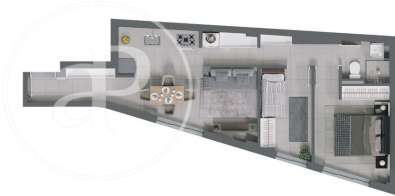

Primera Planta (nivel +3.20m)

SUP. ÚTIL INTERIOR	50,51 m <sup>2</sup>
SUP. CONSTRUIDA INTERIOR	59,95 m <sup>2</sup>
SUP. ÚTIL EXTERIOR	-
SUP. PPZC	76,30 m <sup>2</sup>

- Saló / Comedor / Cocina
- 2 Dormitorios
- 1 Baño



\* Ver anexo. Explicación de superficies.



Planta Segunda (nivel +6.20m)

SUP. ÚTIL INTERIOR	44,47 m <sup>2</sup>
SUP. CONSTRUIDA INTERIOR	55,57 m <sup>2</sup>
SUP. ÚTIL EXTERIOR	-
SUP. PPZC	70,72 m <sup>2</sup>

- Saló / Comedor / Cocina
- 2 Dormitorios
- 1 Baño



\* Ver anexo. Explicación de superficies.

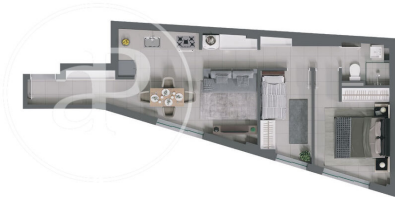

Planta Segunda (nivel +6.20m)

SUP. ÚTIL INTERIOR	50,57 m <sup>2</sup>
SUP. CONSTRUIDA INTERIOR	59,95 m <sup>2</sup>
SUP. ÚTIL EXTERIOR	-
SUP. PPZC	76,30 m <sup>2</sup>

- Saló / Comedor / Cocina
- 2 Dormitorios
- 1 Baño



\* Ver anexo. Explicación de superficies.



Planta Tercera (nivel +9.20m)

SUP. ÚTIL INTERIOR	71,39 m <sup>2</sup>
SUP. CONSTRUIDA INTERIOR	89,2 m <sup>2</sup>
SUP. ÚTIL EXTERIOR	20,94 m <sup>2</sup>
SUP. PPZC	119,40 m <sup>2</sup>

- Saló
- Comedor / Cocina
- 3 Dormitorios
- 2 Baños
- Terraza Privada



\* Ver anexo. Explicación de superficies.



Planta Cuarta (nivel +12.20m)

SUP. ÚTIL INTERIOR	43,66 m <sup>2</sup>
SUP. CONSTRUIDA INTERIOR	55,36 m <sup>2</sup>
SUP. ÚTIL EXTERIOR	30,63 m <sup>2</sup>
SUP. PPZC	77,25 m <sup>2</sup>

- Saló / Comedor / Cocina
- 2 Dormitorios
- 1 Baño
- Terraza Privada



\* Ver anexo. Explicación de superficies.

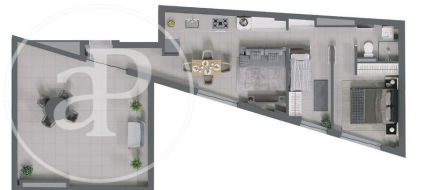

The information about any property is not binding to any offer or contract. Any verbal or written declaration made by aProperties with regards to the value or condition of the property should not be considered accurate or factual. The pictures make reference to some parts of the property at the times that they were taken. The areas, dimensions and distances that are given are approximate and should be checked by the client. The images are computer generated and are just an approximate indication of the real appearance of the property; these may change at any time. The information with regards to the property may also change at any time.

Contact us today for more information or to arrange a viewing

Tel: 871 16 01 60 [apropertiespalma@aproperties.es](mailto:apropertiespalma@aproperties.es) <https://www.aproperties.es>