



Nueva España, Madrid

REF. VM2510005

# Flat for sale in Bernabéu - Hispanoamérica (Madrid)

## Features

- ✓ Heating
- ✓ AACC
- ✓ Lift
- ✓ Furnished
- ✓ Terrace
- ✓ Concierge

Price

**1,200,000 €**

Surface  
**122 m<sup>2</sup>**

Bedrooms  
**2**

Bathrooms  
**2**



**Discover this spectacular penthouse in a charming building located on the prestigious Paseo de la Habana.**

The property stands out for its natural light and multiple orientations, offering a warm and welcoming atmosphere in every corner. The home is divided into two bedrooms, one with an en-suite bathroom, plus another full bathroom, for a total of two. The generously sized kitchen is equipped with high-end appliances and has a dining area perfectly integrated into the living room. It also has an additional terrace, creating a perfect space for entertaining and providing a wonderful flood of natural light. This penthouse combines luxury, functionality, and a prime

location, ideal for those seeking an exclusive home in one of the most sought-after areas of the city. The property is undergoing a comprehensive renovation, with completion date estimated at the end of October. Hispanoamérica is a quiet residential neighborhood in the Chamartín district, located in the northeast of Madrid. It is characterized by its numerous green areas and parks. It's a family-friendly neighborhood with a wide variety of prestigious national and international schools. It's also a dynamic neighborhood with all kinds of shops, restaurants, and services, such as:...

**Contact us,**  
we will be happy to assist you,  
to offer you more details and information.

Nueva España, Madrid

REF. VM2510005

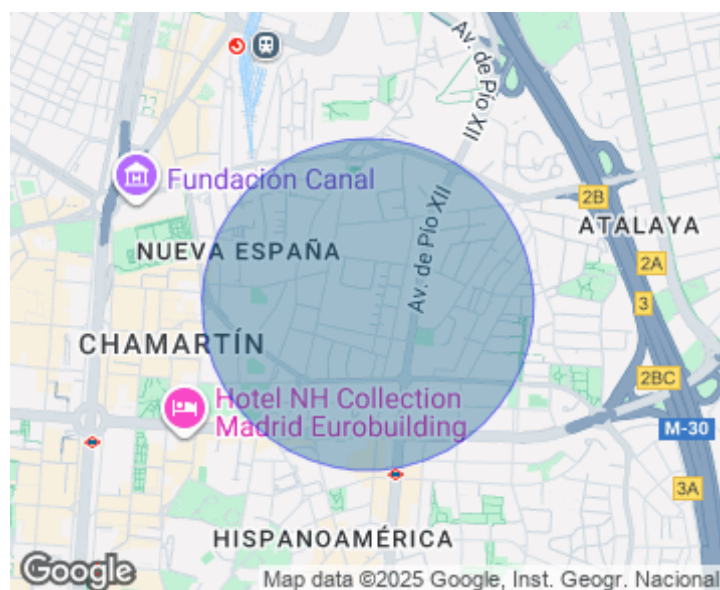
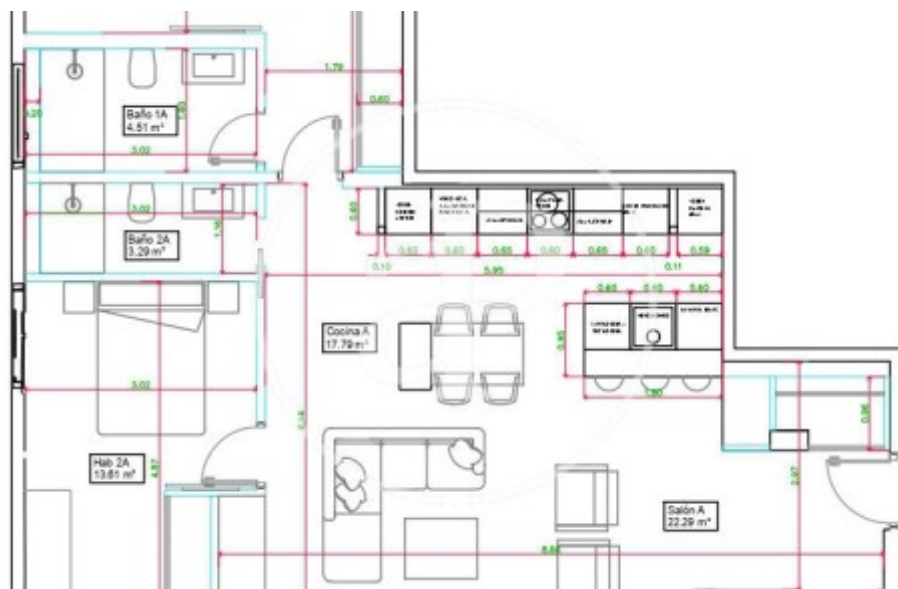



Nueva España, Madrid

REF. VM2510005

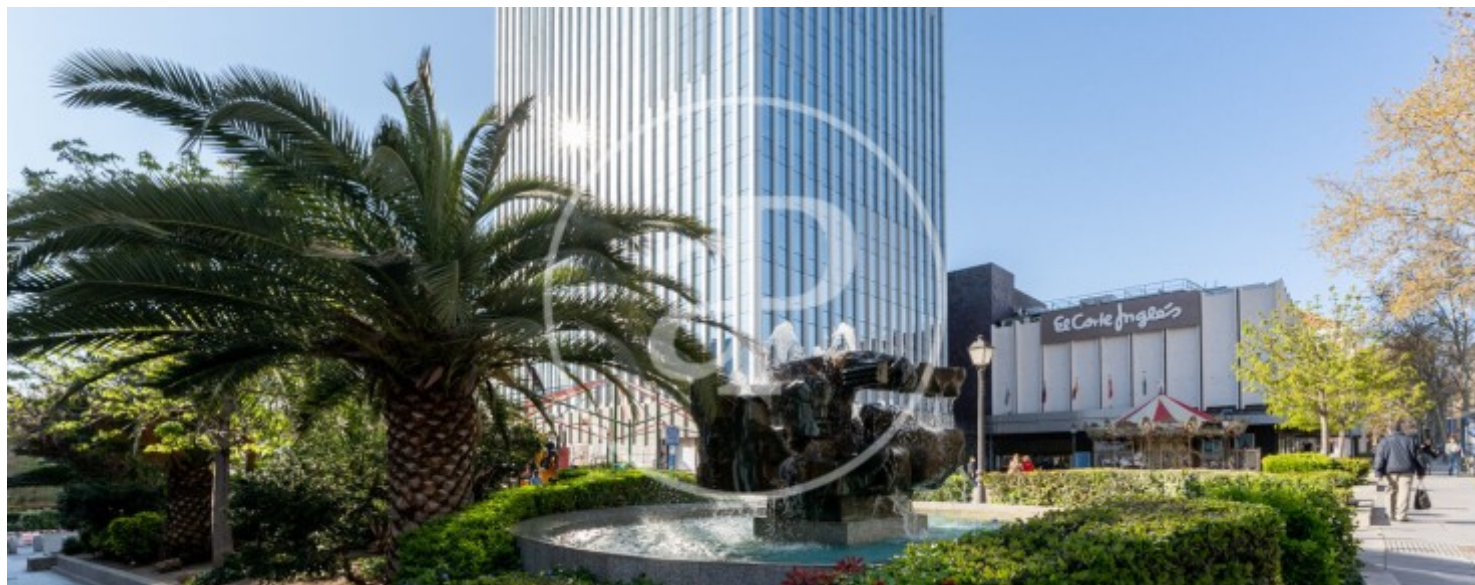

The information about any property is not binding to any offer or contract. Any verbal or written declaration made by aProperties with regards to the value or condition of the property should not be considered accurate or factual. The pictures make reference to some parts of the property at the times that they were taken. The areas, dimensions and distances that are given are approximate and should be checked by the client. The images are computer generated and are just an approximate indication of the real appearance of the property; these may change at any time. The information with regards to the property may also change at any time.

For **more information** or  
to make an appointment

[apropertiesmadrid@aproperties.es](mailto:apropertiesmadrid@aproperties.es)  
Tel: 91 800 54 65  
[www.aproperties.es](http://www.aproperties.es)