

(Estrella)

Ref: ONM2605002



## NAKTAM RESIDENCES

In the prestigious La Estrella neighborhood, in Madrid's Retiro district, NAKTAM emerges: an architectural project that redefines the way of living in the capital. ARCHITECTURE THAT MAKES AN IMPRESSION Designed by the acclaimed Cano y Escario Arquitectura studio, NAKTAM rises across 15 floors in a unique cascading terrace design, creating a fluid and organic silhouette that blends seamlessly with Madrid's skyline. Curved forms inspired by nature. Clean lines that express modernity. A prefabricated GRC façade that has become an architectural landmark in the neighborhood. PRIVILEGED VIEWS Each residence features spacious terraces with panoramic views over Madrid's skyline — Torrespaña, the parks, and the city unfolding like a living canvas. 87 MOVE-IN READY HOMES From 1 to 4 bedrooms, with parking space and storage room included. Generous layouts, intelligent designs, and premium-quality finishes. Everything is ready for you to simply bring your belongings and start living. TRUE SUSTAINABILITY Nearly zero-energy homes featuring: Centralized aerothermal energy system Photovoltaic panels High-efficiency thermal and acoustic [...]

Madrid / Estrella

Unit 14 A

Completion Q2 2026

### FEATURES

Surface 174 m<sup>2</sup> / 86 m<sup>2</sup> terrace

3 Rooms

2 Toilets 1 Restrooms

- ✓ Views
- ✓ Heating
- ✓ Furnished
- ✓ Boxroom
- ✓ Terrace
- ✓ Backyard
- ✓ Pool
- ✓ Gym
- ✓ Lift
- ✓ Security
- ✓ Concierge
- ✓ Has parking

Price 1,950,000 €

(Estrella)

Ref: ONM2605002

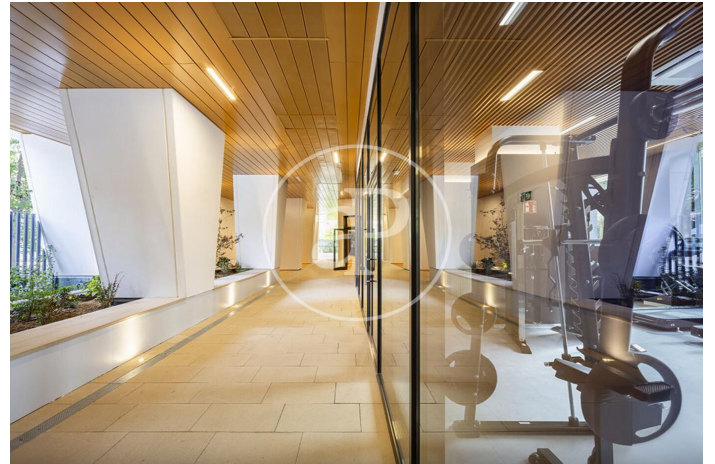



APROPERTIES  
REAL ESTATE

Calle Serrano 60  
Tel: 91 800 54 65  
<https://www.aproperties.es>

(Estrella)

Ref: ONM2605002

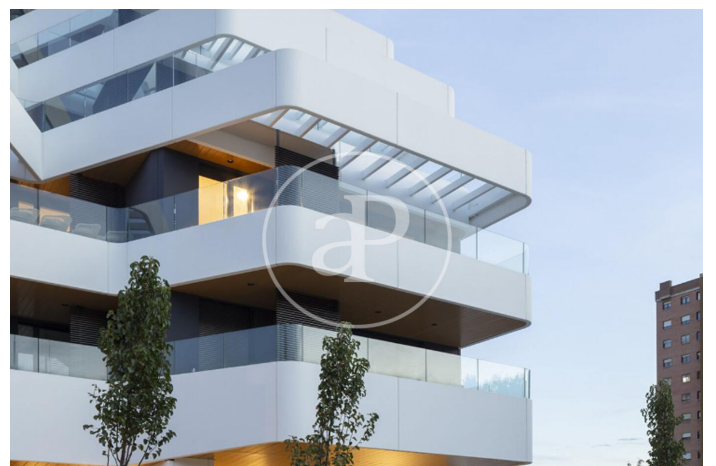

(Estrella)

Ref: ONM2605002



The information about any property is not binding to any offer or contract. Any verbal or written declaration made by aProperties with regards to the value or condition of the property should not be considered accurate or factual. The pictures make reference to some parts of the property at the times that they were taken. The areas, dimensions and distances that are given are approximate and should be checked by the client. The images are computer generated and are just an approximate indication of the real appearance of the property; these may change at any time. The information with regards to the property may also change at any time.

Contact us today for more information or to arrange a viewing

Tel: 91 800 54 65 [apropertiesmadrid@aproperties.es](mailto:apropertiesmadrid@aproperties.es) <https://www.aproperties.es>