

(Palomas)

Ref: ONM2311003



### *New development in Calle de los Andes.*

Be one of the new owners of this spectacular project that combines modernity, beauty and nature. In a privileged location, next to El Corte Inglés del Campo de las Naciones, IFEMA, Juan Carlos I Park, Juan Pablo II Park and first class educational centres, such as Montessori School, Liceo Francés, San José del Parque School, Nuestra Señora Santa María School and Bristol School, among others. The properties stand out for their large terraces and spacious interiors. All have 3 double bedrooms, 2 or 3 bathrooms, separate laundry room and the option of choosing between a separate or integrated kitchen, with spaces of up to 43 m<sup>2</sup>. All homes include a storage room and 2 or 3 parking spaces. Enjoy the spacious communal areas with gardens, saltwater swimming pool, paddle tennis court, co-living room with wifi and a gastroteca, community room with home cinema and gymnasium with changing rooms and sauna. Can you imagine living here?

#### Hortaleza / Palomas

Surface  
139 m<sup>2</sup> - 156 m<sup>2</sup>

Units

6

Completion  
Q3 2023

- |            |               |
|------------|---------------|
| ✓ Heating  | ✓ Lift        |
| ✓ Boxroom  | ✓ Security    |
| ✓ AACC     | ✓ Concierge   |
| ✓ Terrace  | ✓ Has parking |
| ✓ Backyard |               |
| ✓ Pool     |               |
| ✓ Gym      |               |

Price from 1,052,000 €



(Palomas)

Ref: ONM2311003

Units in this development

Type	Unit	Surface	Terrace	Bedrooms	Bathrooms	Price	State
Flat	1° P7-1B	156 m²	1 ( 9 m²)	3	3	€ 1,052,000	Available

(Palomas)

Ref: ONM2311003

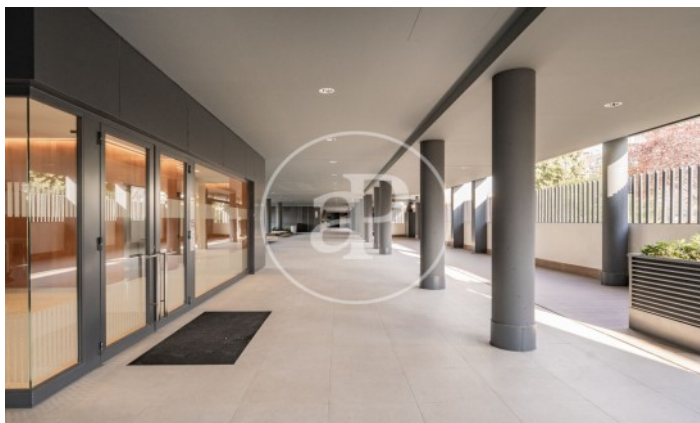
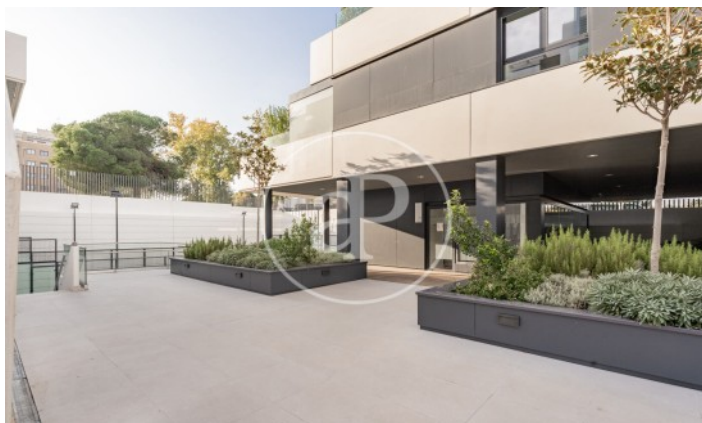



(Palomas)

Ref: ONM2311003

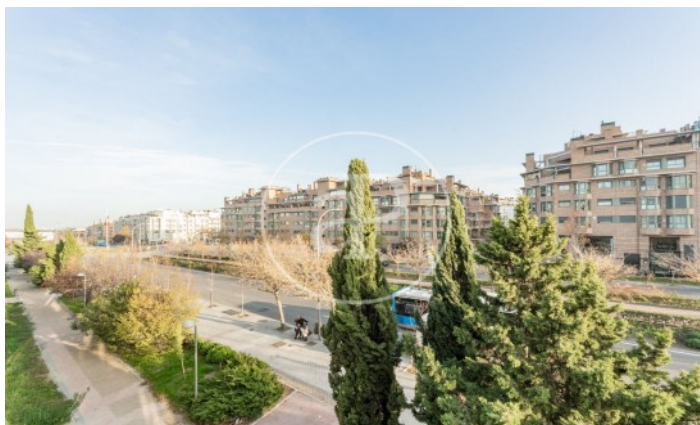
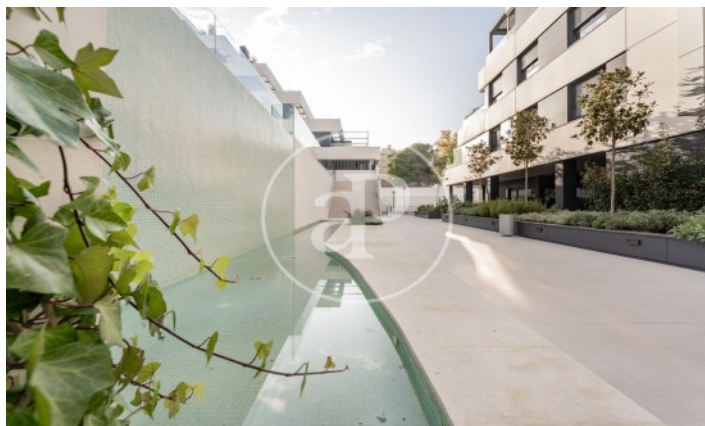

(Palomas)

Ref: ONM2311003



The information about any property is not binding to any offer or contract. Any verbal or written declaration made by aProperties with regards to the value or condition of the property should not be considered accurate or factual. The pictures make reference to some parts of the property at the times that they were taken. The areas, dimensions and distances that are given are approximate and should be checked by the client. The images are computer generated and are just an approximate indication of the real appearance of the property; these may change at any time. The information with regards to the property may also change at any time.

Contact us today for more information or to arrange a viewing

Tel: 91 800 54 65

[apropertiesmadrid@aproperties.es](mailto:apropertiesmadrid@aproperties.es)

<https://www.aproperties.es>