

(Valdemarín)

Ref: ONM2403003



### *New build villas in Valdemarín*

Project of 19 homes with garden, swimming pool and penthouse terrace 7 minutes from the city centre. It is located in a natural environment with views of the skyline of Madrid and the Sierra de Guadarrama. Being semi-detached only for the staircase and lift space generates an acoustic independence between them. The large windows and double-height spaces directly connected to their private gardens allow for cross ventilation. The functionality and versatility of the project's floor plan solution allows the personalisation and adaptation of each home according to the needs and tastes of each owner. With efficient geothermal air conditioning and refrigerated underfloor heating, these homes represent an architectural ensemble that takes care of quality, design and also consumption. Can you imagine living here?

Aravaca / Valdemarín

Surface  
421 m<sup>2</sup> - 421 m<sup>2</sup>  
Units  
19  
Completion  
Q3 2024

- ✓ Views
- ✓ Heating
- ✓ Terrace
- ✓ Backyard
- ✓ Pool
- ✓ Lift

PRICE UPON REQUEST



APROPERTIES  
REAL ESTATE

Calle Serrano 60  
Tel: 91 800 54 65  
<https://www.aproperties.es>

(Valdemarín)

Ref: ONM2403003

Units in this development

(Valdemarín)

Ref: ONM2403003



(Valdemarín)

Ref: ONM2403003

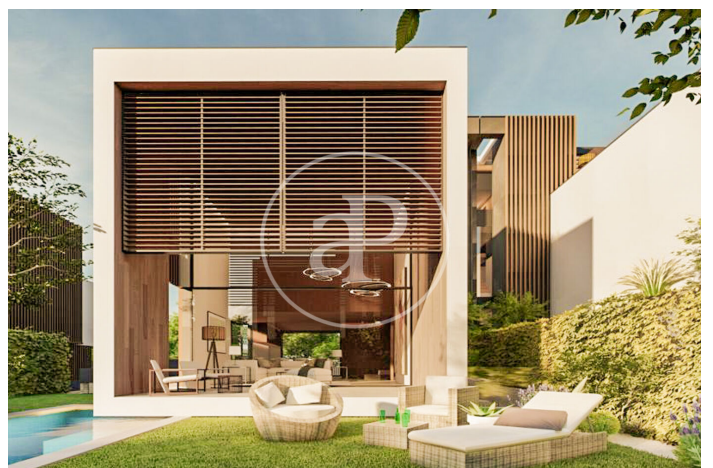

(Valdemarín)

Ref: ONM2403003



The information about any property is not binding to any offer or contract. Any verbal or written declaration made by aProperties with regards to the value or condition of the property should not be considered accurate or factual. The pictures make reference to some parts of the property at the times that they were taken. The areas, dimensions and distances that are given are approximate and should be checked by the client. The images are computer generated and are just an approximate indication of the real appearance of the property; these may change at any time. The information with regards to the property may also change at any time.

Contact us today for more information or to arrange a viewing

Tel: 91 800 54 65 [apropertiesmadrid@aproperties.es](mailto:apropertiesmadrid@aproperties.es) <https://www.aproperties.es>